



11920 FORGE PLACE RICHMOND, BC
18,861 SF OF BRAND NEW DOCK AND GRADE LOADING
WAREHOUSE FOR PURCHASE

UNITS 107 & 108





UNIT DETAILS

Unit	Main Floor SF	Mezzanine SF	Total SF
107	7,158	2,070	9,228
108	7,471	2,162	9,633
Total	14,629	4,232	18,861

Units can be purchased individually or together

Contact listing agents for pricing

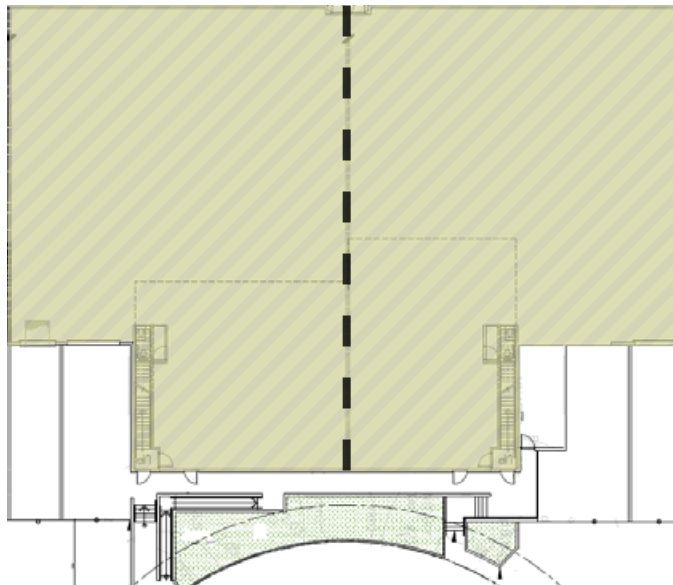

UNIT HIGHLIGHTS



CONSTRUCTION

Concrete tilt up construction



LOADING

2 Dock loading doors
2 Grade loading doors



CEILING HEIGHT

28' clear warehouse
ceiling height



FLOOR LOAD

Sealed concrete ground floor
with 600 pounds PSF capacity



ADJOINING DOORS

Roll up door in the warehouse
Door in office mezzanine



POWER

3- phase electrical per unit



ACCESSIBILITY

Completed washroom
downstairs per unit



EXPECTED DELIVERY

Summer 2024



ZONING

IB-1 (Industrial Business Park)

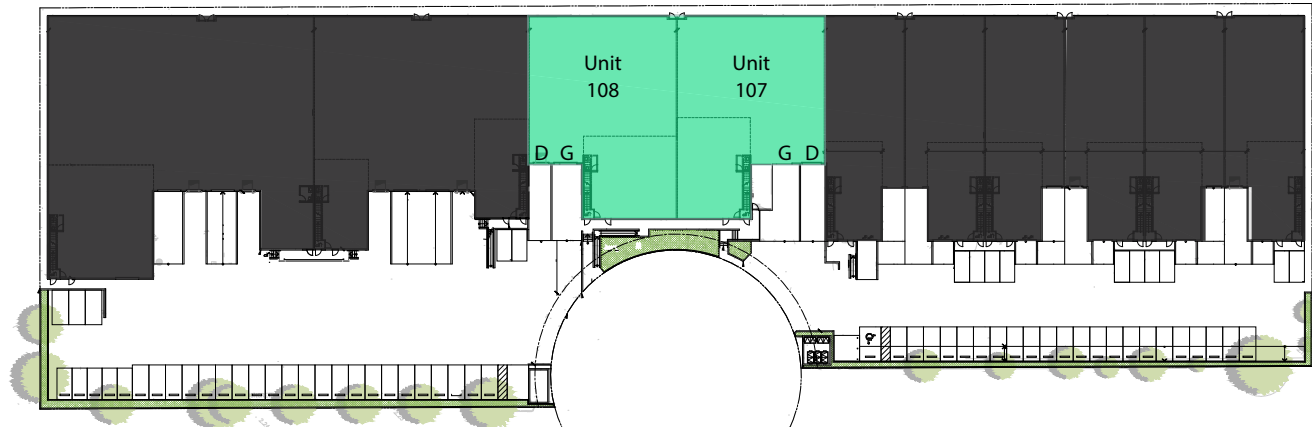

CONTACT US

Alex Mei 梅嘉俊

PERSONAL REAL ESTATE CORPORATION

Associate Vice President
Industrial Properties Group
alex.mei@cbre.com
778 788 3106

Joel Barnett

PERSONAL REAL ESTATE CORPORATION

Executive Vice President
Industrial Properties Group
joel.barnett@cbre.com
604 662 5570

Steve Brooke

PERSONAL REAL ESTATE CORPORATION

Senior Vice President
Industrial Properties Group
steve.brooke@cbre.com
604 662 5147

Luc Soares

Sales Associate
Industrial Properties Group
luc.soares@cbre.com
778 372 1938

theindustrialspecialists.com

This disclaimer shall apply to CBRE Limited, Real Estate Brokerage, and to all other divisions of the Corporation; to include all employees and independent contractors ("CBRE"). All references to CBRE Limited herein shall be deemed to include CBRE, Inc. The information set out herein, including, without limitation, any projections, images, opinions, assumptions and estimates obtained from third parties (the "Information") has not been verified by CBRE, and CBRE does not represent, warrant or guarantee the accuracy, correctness and completeness of the Information. CBRE does not accept or assume any responsibility or liability, direct or consequential, for the Information or the recipient's reliance upon the Information. The recipient of the Information should take such steps as the recipient may deem necessary to verify the Information prior to placing any reliance upon the Information. The Information may change and any property described in the Information may be withdrawn from the market at any time without notice or obligation to the recipient from CBRE. CBRE and the CBRE logo are the service marks of CBRE Limited and/or its affiliated or related companies in other countries. All other marks displayed on this document are the property of their respective owners. All Rights Reserved. Mapping Sources: Canadian Mapping Services canadamapping@cbre.com; DMTI Spatial, EnviroNics Analytics, Microsoft Bing, Google Earth.



VANCOUVER

HIGHWAY 99

SHELL ROAD

NO. 5 ROAD

STEVESTON HIGHWAY



CBRE