



For Lease

PRIME INDUSTRIAL RETAIL UNIT FOR
LEASE ALONG BRIDGEPORT ROAD

UNIT 130-12020
BRIDGEPORT ROAD
RICHMOND, BRITISH COLUMBIA

THE
INDUSTRIAL
SPECIALISTS
CBRE

unit 130

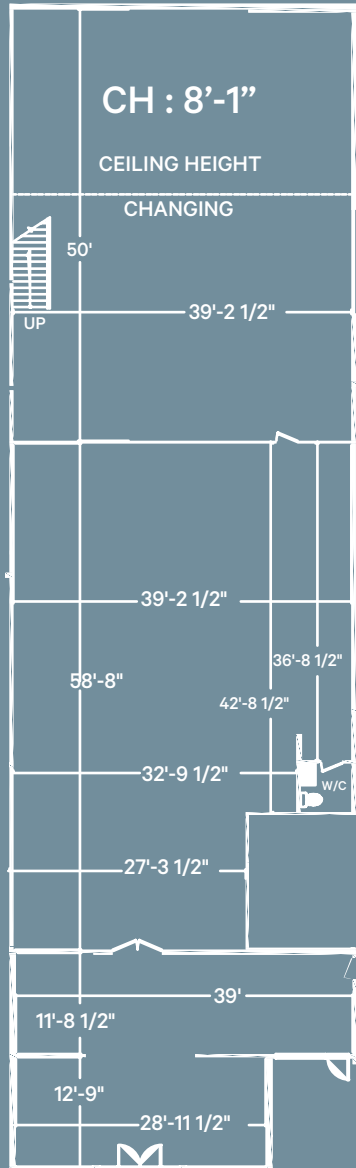

FLOOR PLAN NOT TO SCALE

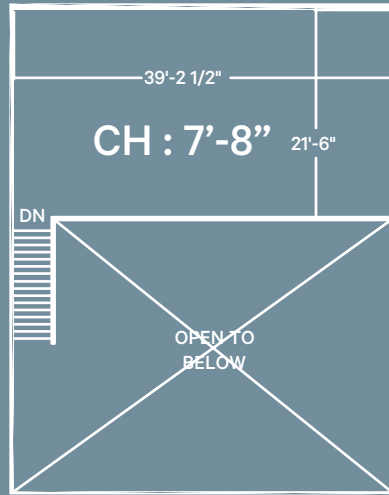

Unit size

5,061 SF (1st floor)

961 SF (2nd floor)

6,022 SF Total area

IR-1 Zoning

Industrial retail - allowing a wide range of retail and warehousing uses

Basic Rent	\$29.00 PSF
Additional Rent	\$6.00 PSF (2024 est.)
Loading	Grade level loading
Parking	58 shared parking stalls
Availability	Immediate

Features

- High exposure along Bridgeport Road
- Highly finished showroom unit
- Dedicated signposts for additional exposure



UNIT 130-12020 BRIDGEPORT ROAD

RICHMOND, BRITISH COLUMBIA



Location

The property is conveniently located at the intersection of Bridgeport Road and No. 5 Road, one of the busiest arterials for industrial retail in Richmond. The location allows for convenient access to all of Metro Vancouver as well as YVR International Airport and Deltaport. The property benefits from the numerous anchor businesses nearby including IKEA, The Home Depot, and Staples that bring added exposure to the property.

Driving Time

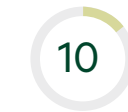

MIN TO YVR AIRPORT



MIN TO RICHMOND CENTRE



MIN TO OAKRIDGE CENTRE



MIN TO DELTAPORT

Alex Mei 梅嘉俊

Personal Real Estate Corporation
Associate Vice President
Industrial Properties Group
778 788 3106
alex.mei@cbre.com

Joel Barnett

Personal Real Estate Corporation
Executive Vice President
Industrial Properties Group
604 662 5570
joel.barnett@cbre.com

Steve Brooke

Personal Real Estate Corporation
Senior Vice President
Industrial Properties Group
604 662 5147
steve.brooke@cbre.com

Connect with us for more information

theindustrialspecialists.com

CBRE

JOIN OUR MAILING LIST & BE THE FIRST TO KNOW!



CBRE Limited | 1021 West Hastings Street #2500, Vancouver, BC V6E 0C3 | cbre.ca

This disclaimer shall apply to CBRE Limited, Real Estate Brokerage, and to all other divisions of the Corporation; to include all employees and independent contractors ("CBRE"). All references to CBRE Limited herein shall be deemed to include CBRE, Inc. The information set out herein, including, without limitation, any projections, images, opinions, assumptions and estimates obtained from third parties (the "Information") has not been verified by CBRE, and CBRE does not represent, warrant or guarantee the accuracy, correctness and completeness of the Information. CBRE does not accept or assume any responsibility or liability, direct or consequential, for the Information or the recipient's reliance upon the Information. The recipient of the Information should take such steps as the recipient may deem necessary to verify the Information prior to placing any reliance upon the Information. The Information may change and any property described in the Information may be withdrawn from the market at any time without notice or obligation to the recipient from CBRE. CBRE and the CBRE logo are the service marks of CBRE Limited and/or its affiliated or related companies in other countries. All other marks displayed on this document are the property of their respective owners. All Rights Reserved. Mapping Sources: Canadian Mapping Services canadamapping@cbre.com; DMTI Spatial, EnviroNics Analytics, Microsoft Bing, Google Earth.